

# FIRE PLAN & EQUIPMENT LOCATION

## VOLUNTEER

120' X 37' X 18'  
 TWIN SCREW TUG  
 BUILT BY: BOLLINGER  
 OFFICIAL Number 653464  
 HULL Number 158  
 H.P. 4806

### CAPACITY SUMMARY

FUEL OIL.....86,584  
 LUBE OIL.....3,330  
 BALLAST.....62,862  
 POT. WATER.....11,648  
 WASH WATER..  
 SEWERAGE.....2,101

- Fire Pulls
- Smoke Alarm
- Heat Detector
- CO 2 Pulls
- Alarm Bell
- General Alarm Switch
- Fire Hydrant
- Fire Axe
- Co2 Extinguisher
- Dry Chemical Extinguisher
- Fire Pump
- Emrg. Lights
- Fuel Pump Remote
- Fire Pump Remote
- SCBA
- Vent Shutdown

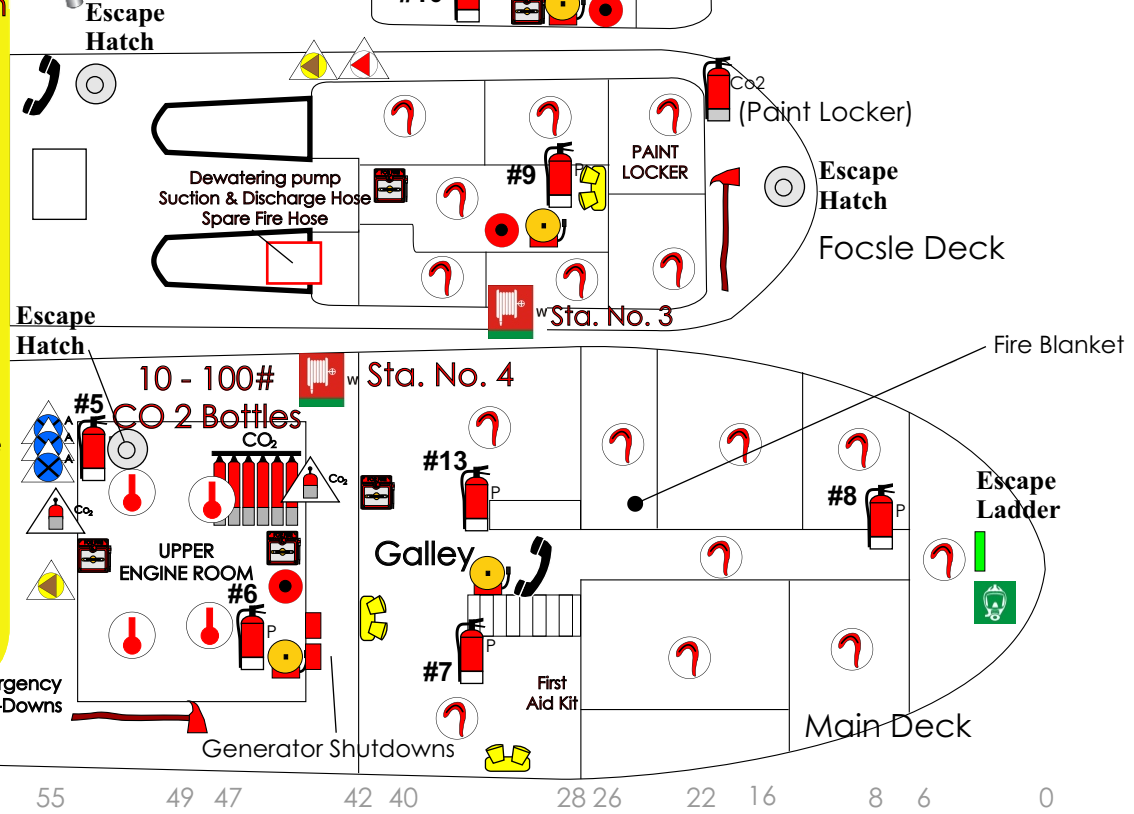

70 63 55 49 47 42 40 28 26 22 16 8 6 0

