

# FIRE PLAN & EQUIPMENT LOCATION

## DOLPHIN

120.2' X 34' X 16.3'  
 TWIN SCREW TUG  
 BUILT : 1973 - McDermott  
 OFFICIAL Number 5506530  
 IMO # 73190100  
 HULL Number 181  
 H.P. 4,300

**CAPACITY SUMMARY**  
 FUEL OIL.....111,000  
 LUBE OIL.....2,052  
 BALLAST.....  
 POT. WATER....11,000

- Fire Detection Panel
- General Alarm
- Smoke Detector
- Heat/Smoke Sensor
- Fire Alarm Pulls
- Co2 Pulls
- Fire Station
- Fire Axe
- General Alarm Pull
- Firemen's Outfit
- Survival Suit
- Life Jacket
- EEPD
- Breathing Apparatus
- Life Ring w/Light
- Epibr
- Co2 Extinguisher
- Dry Chem Extinguisher
- Oxygen Bottle
- Fire Pump
- Fire Pump Remote
- Ventilation Shutdown
- Fuel Pump Shutdown
- Emerg Lights
- Defibrillator
- First Aid Kit
- Electric Panel
- Co2 Bottle Bank
- Co2 Horn
- Alarm & Strobe Lights
- Flares

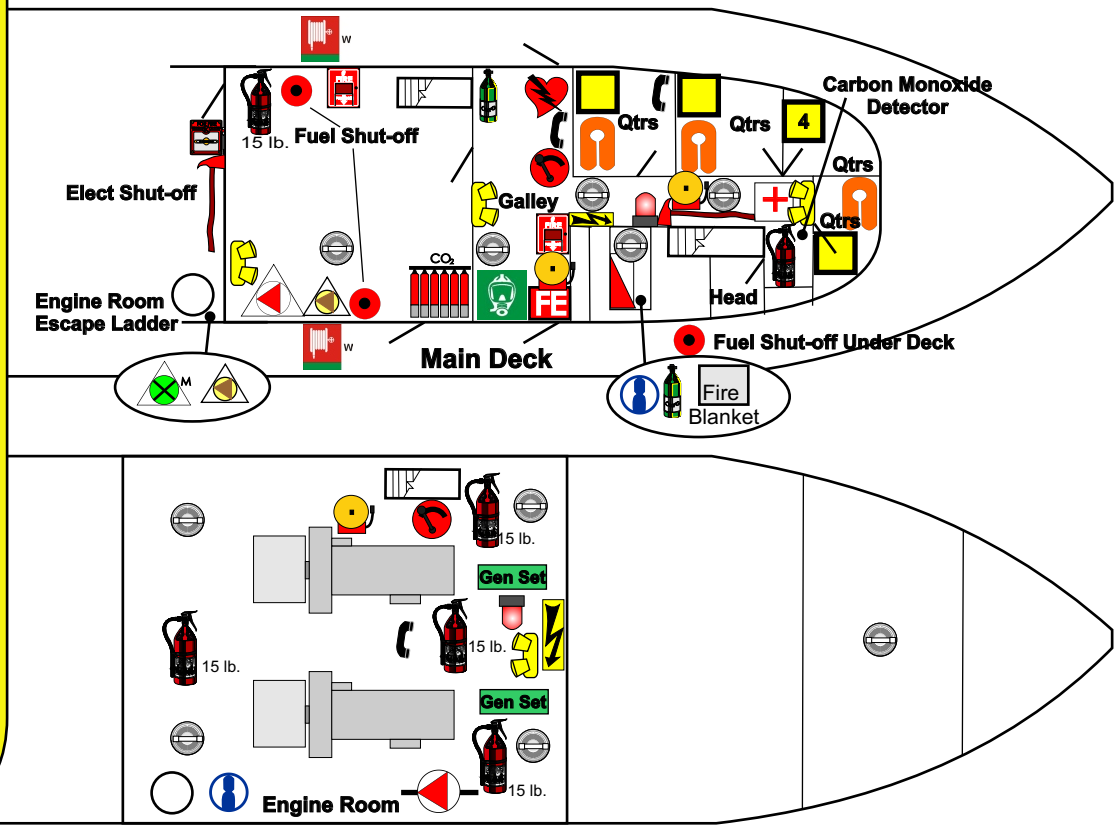
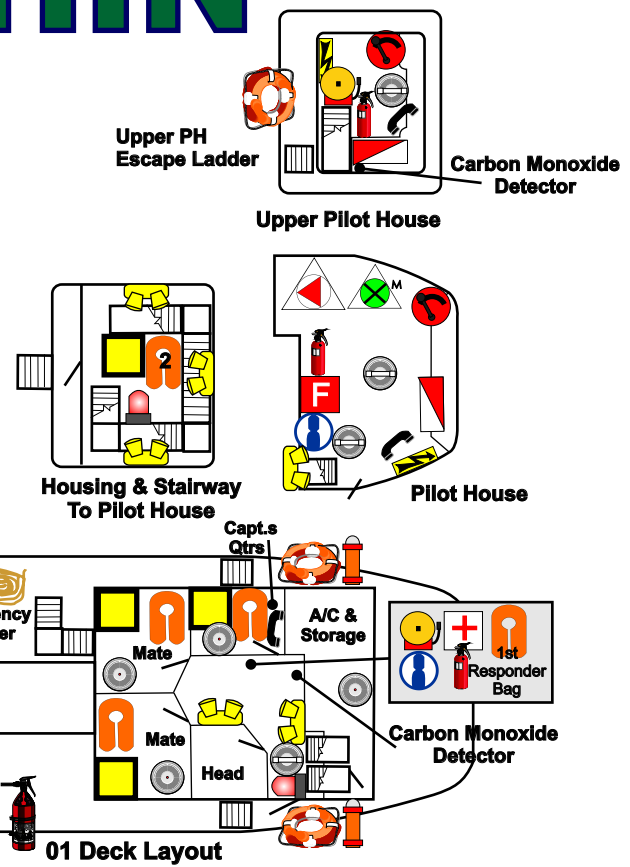

Engine Room  
 Escape Ladder