

DBL 105 Fire Plan

- Dry Chemical Fire Extinguisher
- Co2 Fire Extinguisher
- Fire Axe
- SCBA
- Life Ring
- Life Ring w/Light
- Shut Down
- Machinery Space Blower Shutdown
- Survival Suit

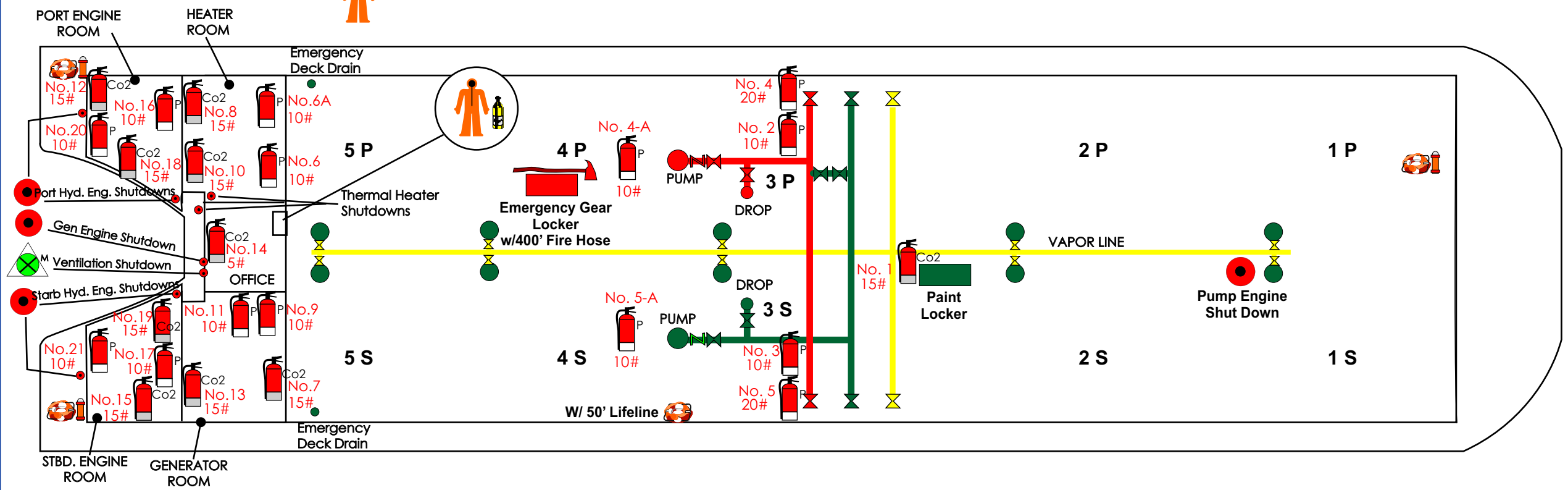

420'11" X 78' X 29'	CAPACITY - 105,000 BARRELS		BALLAST CAPACITY (BARRELS)	
OPA 90 DOUBLE HULL BARGE	@ 100%		FOREPEAK - 11595.2	
YEAR REBUILT : 2004	1 PORT - 11780.1	1 STARB - 11780.1	1 PORT - 4144.2	1 STARB - 4144.2
OFFICIAL No. 653463	2 PORT - 11219.2	2 STARB - 11219.2	2 PORT - 4615.3	2 STARB - 4615.3
GROSS TONS: 7659	3 PORT - 11219.2	3 STARB - 11219.2	3 PORT - 4384.7	3 STARB - 4384.7
PUMPS - 2 DEEPWELLS	4 PORT - 11593.1	4 STARB - 11593.1	4 PORT - 4607.2	4 STARB - 4607.2
	5 PORT - 11780.1	5 STARB - 11780.1	5 PORT - 2504.7	5 STARB - 3009.1
			AFT PEAK PORT - 3596	AFT PEAK STARB - 3596